



TOYOTA



report date: 2024-03-29

General information

Make	TOYOTA
Model	AVENSIS D-4D BUSINESS EDITION
Colour	Silver
Year of manufacture	2016
Top speed	124 mph
0 - 60 mph	9.2 seconds
Gearbox	6 speed Manual

Engine & fuel consumption

Power	141 BHP
Max. torque	320 Nm at 2.250 rpm
Engine capacity	1.995 cc
Cylinders	4
Fuel type	Diesel
Consumption city	49.6 mpg
Consumption extra urban	74.3 mpg
Consumption combined	62.8 mpg
CO2 emission	119 g/km
CO2 label	C





Internet history

Entry 2

Date	2021-08-04
Pictures	34
Listing price	View report

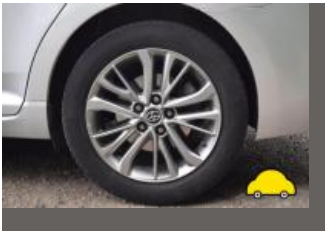
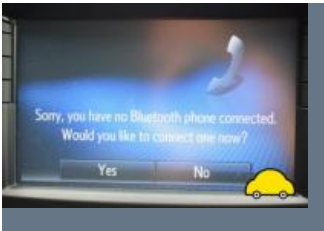

source: cargurus.co.uk

Entry 1

Date	2021-08-02
Pictures	0
Listing price	View report

source: autotrader.co.uk



MOT history

MOT expiry date	2025-04-10
MOT pass rate	100 %
MOT passed	9
Failed MOT tests	0
Total advice items	7
Total items failed	0

MOT #9 2024-04-08 15:57

MOT test number 396933194519

Result ✓ Passed

Next expiry date 2025-04-10

Advice Offside Rear Tyre worn close to legal limit/worn on edge (5.2.3 (e))

Advice Nearside Front Tyre worn close to legal limit/worn on edge (5.2.3 (e))

Advice Offside Front Tyre worn close to legal limit/worn on edge (5.2.3 (e))

MOT #8 2023-04-11 14:15

MOT test number 640236233537

Result ✓ Passed

MOT #7 2022-03-16 17:09

MOT test number 365070379592

Result ✓ Passed

Advice Front Brake disc worn, pitted or scored, but not seriously weakened (1.1.14 (a) (ii))

Advice Front Service brake fluctuating, but not excessively (1.2.1 (e))

Minor Nearside Registration plate lamp inoperative in the case of multiple lamps or light sources (4.7.1 (b) (i))



MOT #6	2021-04-10 08:40
---------------	------------------

MOT test number	701435733308
------------------------	--------------

Result	✓ Passed
---------------	----------

MOT #5	2020-04-02 14:19
---------------	------------------

MOT test number	653419259293
------------------------	--------------

Result	✓ Passed
---------------	----------

MOT #4	2020-01-15 14:51
---------------	------------------

MOT test number	191340157593
------------------------	--------------

Result	✓ Passed
---------------	----------

MOT #3	2019-07-15 16:01
---------------	------------------

MOT test number	787591869877
------------------------	--------------

Result	✓ Passed
---------------	----------

MOT #2	2018-07-27 11:13
---------------	------------------

MOT test number	338481953132
------------------------	--------------

Result	✓ Passed
---------------	----------

Advice	Rear Brake pad(s) wearing thin (1.1.13 (a) (ii))
---------------	--

MOT #1	2017-05-05 13:22
---------------	------------------

MOT test number	958485816507
------------------------	--------------

Result	✓ Passed
---------------	----------



Tax & MOT check

✓
Taxed
Tax due:
1 November 2024

✓
MOT
Expires:
10 April 2025

Tax status	Valid until 1 November
Days left	186
MOT expiry date	10 April 2025
Full MOT history	See MOT history

Tax calculation

Vehicle class	49
Band	C
Single payment (12 months)	£ 35,00,-
Single six month payment	Not applicable
Total payable by 12 monthly instalments	£ 36,75,-



Damage history

Check the damage history for this TOYOTA. See if, where and when this TOYOTA had damage and the car repair costs. We also check if this TOYOTA was scrapped. Download the premium report [here](#) for the results.

Damage 1

Date	
Category	
Type	



Damage 2

Date	
Category	
Type	

Extra TOYOTA salvage check



If this vehicle was seen at a salvage auction we offer: vehicle pictures, salvage location, retail value. Download the premium report [here](#) for more information.

More info >



Vehicle valuation

What is this car worth? See the vehicle value of this TOYOTA in the premium report. We check: purchase value, age, mileage, MOT history, damages and online sale prices.

Trade retail value	£ 19,999
Auction value	£ 19,999
Average private trade value	£ 19,999

More info >



Owner history

For how long did the current and previous owner(s) have this TOYOTA? How many owners did this TOYOTA have? Check it in the premium report and see all owner registrations. Download the full report [here](#).

Owner	Registration
Owner	Registration
Owner	Registration
Owner	Registration
Owner	Registration
Owner	Registration
Owner	Registration

More info >

Plate changes

See in this check if this TOYOTA had different number plates.

Number of plates	1
Current registration	
Plate since	2024-03-29
Current registration	
Plate since	2024-03-29

More info >



Finance check

Check if this TOYOTA is financed, has an outstanding loan or finance agreement. If you are purchasing a vehicle it is smart to ensure that any finance that may have been taken out on this TOYOTA has been settled. If not, and you buy this TOYOTA then you could lose the money and the car you paid for. Download the premium report [here](#) and check if this TOYOTA is financed.

Finance company	XXXXXXXXXX	XXXX
Date of agreement	XXXXXXXXXX	XXXX
Agreement type	XXXXXXXXXX	XXXX
Agreement term	XXXXXXXXXX	XXXX
Agreement number	XXXXXXXXXX	XXXX
Contact info	XXXXXXXXXX	XXXX

More info >



Mileage check

Odometer	In miles
Mileage registrations	12
First mileage registration	2016-09-13
Last registration	2024-04-08
Complete history	See info



Registration #1	2016-09-13	21 mi
Registration #2	2017-05-05	10.861 mi
Registration #3	2018-07-27	23.098 mi
Registration #4	2019-07-15	36.762 mi
Registration #5	2020-01-15	41.448 mi
Registration #6	2020-04-02	41.972 mi
Registration #7	2020-05-20	55.277 mi
Registration #8	2020-06-20	55.277 mi
Registration #9	2020-08-20	55.277 mi
Registration #10	2020-10-20	55.277 mi
Registration #11	2020-12-20	55.277 mi
Registration #12	2021-02-20	55.277 mi

More info >



Car features

The TOYOTA factory car options list is only available in the premium report.

S0225	Air conditioning
S0295	
S0482	
S0501	
S0566	
S0567	
S0569	

View the complete TOYOTA factory list for this vehicle [here](#).

More info >

Safety ratings

NCAP rating	★★★★★
Adult	93%
Children	85%
Pedestrian	78%
Safety systems	81%
Overall rating	86%
Video	see crash video



Dimensions & weight

Width	1810 mm
Height	1480 mm
Length	4750 mm
Wheel base	2700 mm
Kerb weight	1535 kg
Max. allowed weight	2100 kg

Additional information

Fuel tank capacity	60 l
Fuel delivery	Direct Injection
Number of doors	4
Number of seats	5

Number of axles	2
Engine number	N470939660